



TRADITIONAL GLASSHOUSES



LAMS Glasshouses

A & LONG BEAUTIFUL STORY BETWEEN US AND OUR GARDENS

What better place is there for relaxation and delight than your garden? We love spending a lot of time in our green havens of peace and that's because Lams is familiar with this feeling that we have been enjoying designing glasshouses for more than 30 years!

LAMS Glasshouses: a 30-year long story that's built to last

At Lams, we have been manufacturing garden glasshouses for more than 30 years. We are a French company and each one of our creations has been designed in our workshops in Vendée. We believe that making our glasshouses in France is paramount to guarantee quality as well as reliability. Come and dive into the world of Lams glasshouses: we offer a complete and varied range of glasshouses along with the necessary equipment and accessories.

Why opting for a glasshouse?

We like dreaming away in our gardens, pampering them and embellishing them, don't we? Our garden is part of our home and it reflects our personality traits: it may be creative, orderly, exuberant, pragmatic... but whatever our styles, when the sun pops through, we all look forward to sharing some quality time with friends and family in our garden if the weather allows us to. We have the solution to expand fun and relaxation time in the garden: a glasshouse!

What's more, your glasshouse is a special place in your garden as it blurs the lines between the indoor and outdoor spaces. Make it a little private bubble sheltered from bad weather, a place to stage your favourite plants for a real live show at home all year round! You can adapt it to your wishes and style.

All the glasshouses in the world!

You may think your perfect glasshouse has to be out there somewhere... It surely is close at hand! It's up to you to choose where to locate it, its size and its functionality. This new space in your home conveys the serenity, peace and quiet you need after a day's work. Your glasshouse is a magical space away from strain which only awaits your creativity and ideas to exist. Is it a place to winter and grow your favourite plants, a garden into your garden, your peaceful haven, a reception room or all at once. In any case, it's a genuine return to the roots in an environment designed by you!

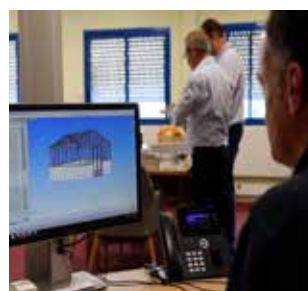

A new world in your garden

Your glasshouse is waiting for you

Go ahead and create your own little corner of paradise in your garden. Whether you want to chill out, entertain or grow your plants, Lams glasshouses provide a solution all year round, safe from dull weather. You only need to select which glasshouse suits your needs the most.

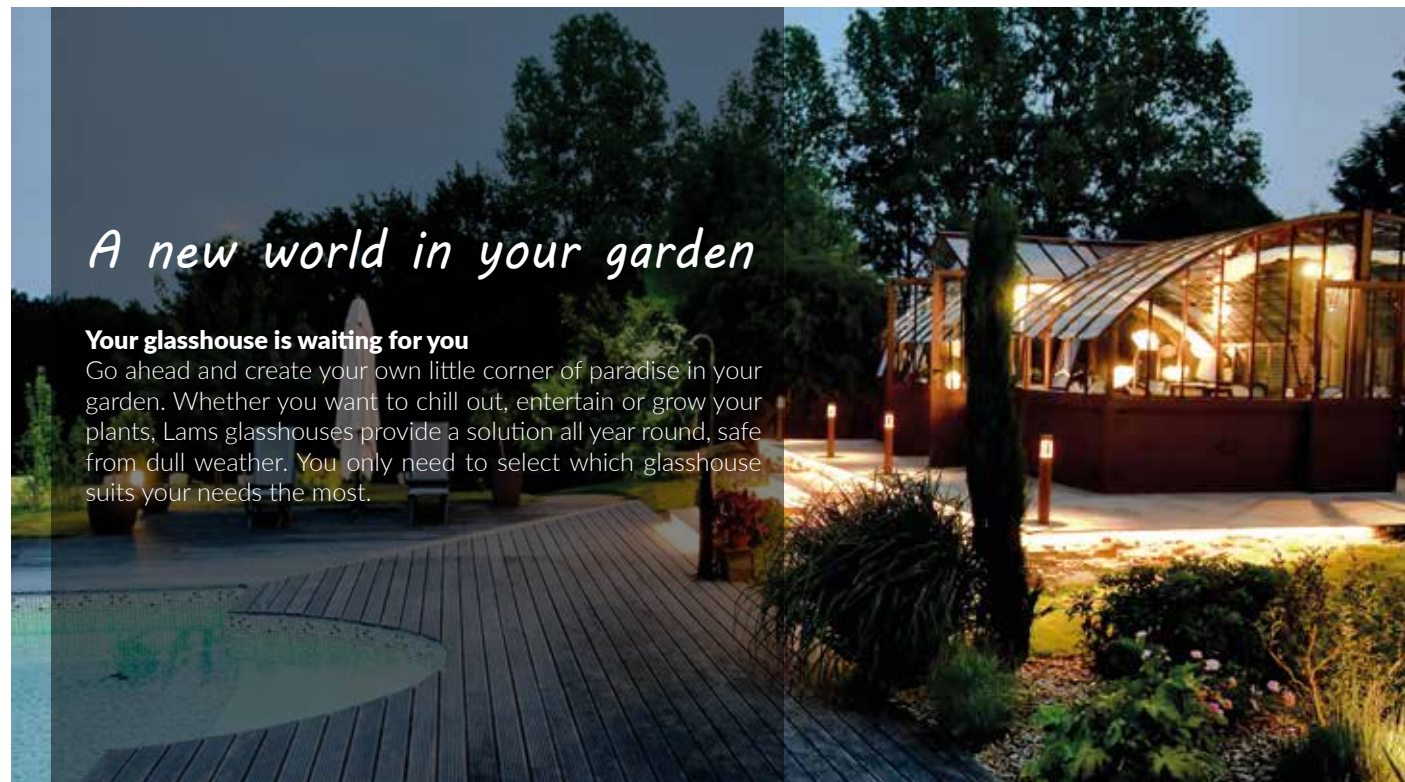

All that is left is to choose

All you have to do is choose the glasshouse of your dreams! You might want to think of the following criteria before making up your mind:

- 1 Location and surface:** Ideally, you will need a sunny place in your garden that is beneficial for your plants to grow, protect them from frost and to naturally heat your glasshouse.
- 2 Style:** Would you choose a lean-to or a freestanding glasshouse? A lean-to glasshouse can be best protected from the wind and frost. A freestanding glasshouse can be installed wherever you want in your garden. However, make sure that it is sufficiently sheltered from winter winds, that the soil is drained and make it easily accessible.
- 3 Intended use:** Do you intend to grow vegetables in it? In the ground or in containers? Do you want to protect your plants and make it a winter garden? Whatever your project is, there is a Lams glasshouse to meet your needs. You can also customise it with extra windows and doors along with a whole range of accessories and equipment.
- 4 Glazing:** Different types of glazing are available: tempered glass for your safety, polycarbonate for perfect insulation, double glazing (hot glasshouses) for your most fragile plants (orchids, exotic plants and all season crops). LAMS also offers solutions for heating, shading and ventilation to meet all your needs.
- 5 Price:** Have a look at our full range, there is a glasshouse for all budgets.



 **LAMS**
Créateur & Fabricant Français de serres depuis 1993





TRADITIONAL GLASSHOUSES

REASONS TO CHOOSE OUR GLASSHOUSE

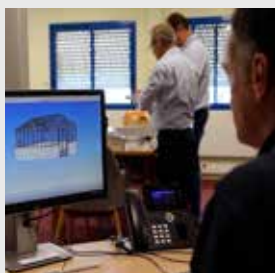

THE FRENCH MANUFACTURING

Manufactured in our workshops in the Vendée, the collection benefits from **30 years of LAMS expertise and know-how.**

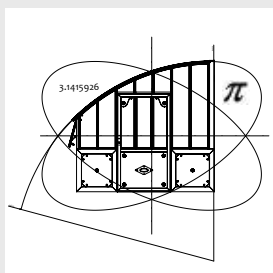

THE LONGEVITY

The aluminium structure and stainless steel hardware of our glasshouses are guaranteed for 15 years. **A glasshouse with quality materials, designed to last.**



THE SAFETY

The glasshouses are equipped with 4 mm **tempered glass**, held in place by stainless steel glazing clips.

LAMS EXCLUSIVITY

THE BASE

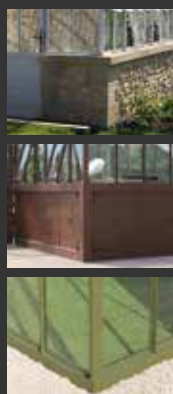

The wall: 40 or 87 cm (15.7 or 34.2 in.) high, to be made of stone, brick or breeze block. A detailed and precise plan for the masonry is provided with the order.

The baseplate: in aluminium, 40 or 87 cm (15.7 or 34.2 in.) high, decorated with decorative elements in relief, it must be placed on a slab or on a concrete strip, perfectly level and square with the supporting wall, if applicable.

The base frame: (only for the Authentique model), in aluminium, 9 cm (3.5 in.) high, it must be placed on a slab or on a concrete strip, perfectly level and square with the supporting wall.

THE USE

Choose the type of glasshouse that suits your needs: a glasshouse that is leaned to your house or any other wall for an extra living space or a glasshouse glazed all round for an independent space in your garden.

THE CHOICE OF COLOURS (depending on the model)

14 colours to choose from
(see page 5).

THE LARGE OPENINGS

Single or double doors in different sizes **facilitate the access** into the glasshouse.

THE QUALITY FINISHES

The decorative mouldings are made of **aluminium smelter**, lacquered in the colour of your glasshouse.

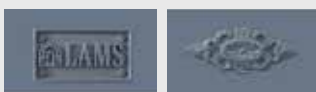

DELIVERY

Your greenhouse will be shipped **within 6 to 8 weeks**, depending on the colors and options.

THE CHOICE OF ACCESSORIES

Dress the roof of your glasshouse with a **ridge cresting from aluminium smelter**, or opt for **additional windows**. To protect your plants and furniture from the sun, add a **shade cloth**.



14 colours to choose from

Choice of matte or gloss finish

	Stone YAZD 2525		Pastel Green RAL 6019		
	Brown red RAL 3011		Anthracite grey RAL 7016		Nut brown RAL 8011
	Sapphire blue RAL 5003		Pebble grey RAL 7032		Chocolate brown RAL 8017
	Olive green RAL 6003		Telegrey 1 RAL 7045		White RAL 9003
	Fir green RAL 6009		Granite grey RAL 7026		Black RAL 9004

OTHERS COLORS AVAILABLE ON DEMAND

SUMMARY

AMBOISE	P 7
MIRABEAU	P13
MONTESQUIEU	P17
VERSAILLES	P21
CHAMBORD	P25
AUTHENTIQUE	P28
CLASSIQUE	P30
DELIVERY	P34
UPCYCLING	P35





AMBOISE

This is the most majestic glasshouse from our range: it perfectly combines the charm of traditional glasshouses with the performance of today's materials. Because the Amboise glasshouse is impressive in size, it is also ideal as an elegant and exceptional reception hall.



33.90 m² (342 ft²) - 6.05 x 5.60 m (19 ft. 10 in. x 18 ft. 5 in.) - Nut brown RAL 8011 matte



The shading system is ideal for sun protection

AMBOISE

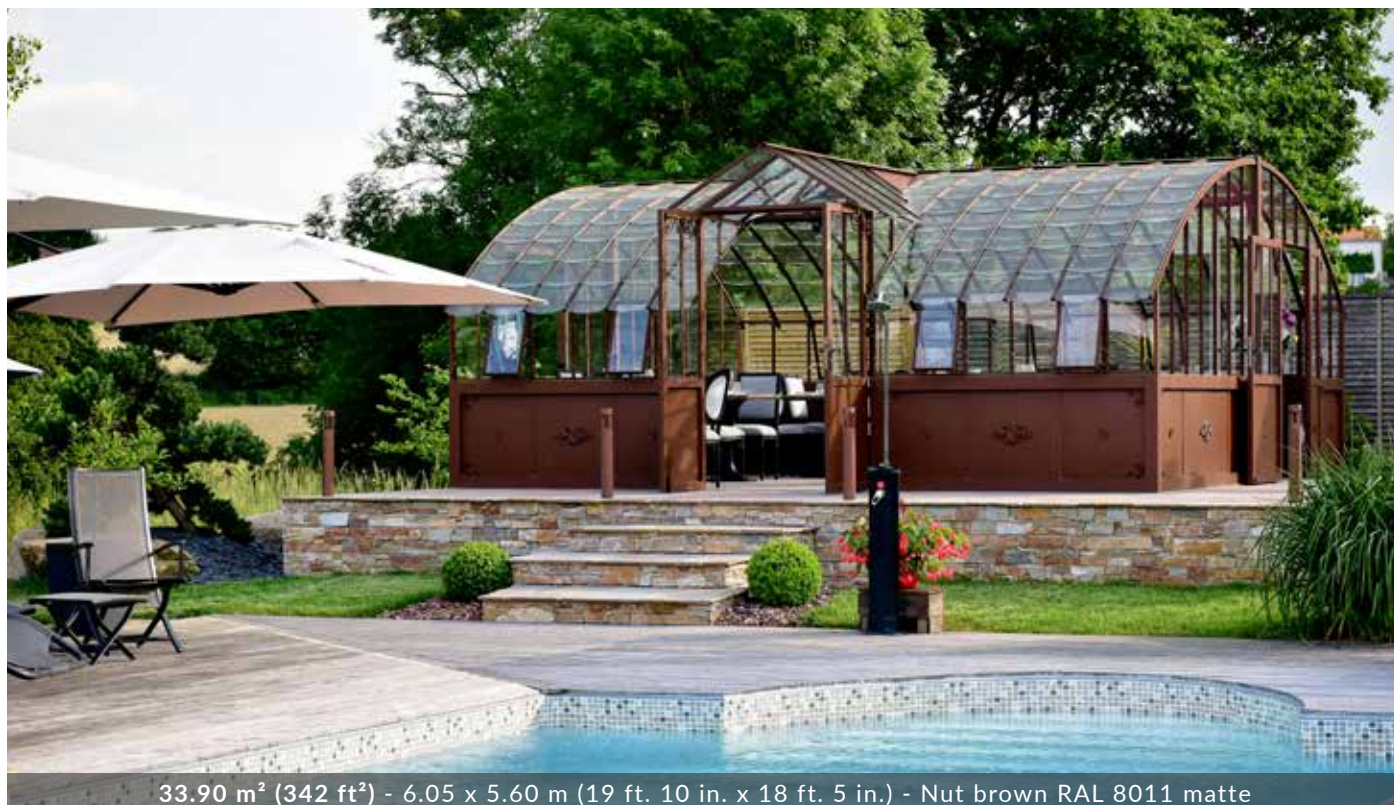

33.90 m² (342 ft²) - 6.05 x 5.60 m (19 ft. 10 in. x 18 ft. 5 in.) - Nut brown RAL 8011 matte

The Amboise glasshouse is available on a **40 cm or 87 cm (15.7 or 34.2 in.)** high wall or aluminium baseplate with a **5.60 m or 7.40 m (18 ft. 5 in. or 24 ft. 3 in.)** width. It is available in 4 lengths from **3.80 to 6.05 m (12 ft. 5 in. to 19 ft. 10 in.)** with a ridge height of **2.70 m or 2.90 m (8 ft. 10 in. or 9 ft. 6 in.)**. Other lengths available on demand.

The Amboise glasshouse is equipped with:

- > an **aluminium structure**, powder-coated with the colour of your choosing
- > **4 mm tempered glass** on the walls and roof
- > a **dormer** on the front side with a **double swing door** (lock included), size 2 doors x l. 0.70 x H. 2.14 m (W. 27.5 in x H. 84.2 in.)
- > a **single swing door** on the side (lock included), size l. 1.00 x H. 1.95 m (W. 39.3 in. x H. 76.7 in.)
- > **4 to 9 windows** depending on the glasshouse length.

WIDTH	LENGTH	HEIGHT	SURFACE	NUMBER OF WINDOWS	
				FRONT	REAR
5.60 m / 18 ft. 5 in.	3.80 m / 12 ft. 5 in.	2.70 m / 8 ft. 10 in.	21.20 m ² / 216 ft ²	2	2
	4.55 m / 14 ft. 11 in.		25.50 m ² / 252 ft ²	2	3
	5.30 m / 17 ft. 4 in.		29.70 m ² / 306 ft ²	4	4
	6.05 m / 19 ft. 10 in.		33.90 m ² / 342 ft ²	4	5

WIDTH	LENGTH	HEIGHT	SURFACE	NUMBER OF WINDOWS	
				FRONT	REAR
7.40 m / 24 ft. 3 in.	3.80 m / 12 ft. 5 in.	2.90 m / 9 ft. 6 in.	28.10 m ² / 301 ft ²	2	2
	4.55 m / 14 ft. 11 in.		33.60 m ² / 355 ft ²	2	3
	5.30 m / 17 ft. 4 in.		39.20 m ² / 420 ft ²	4	4
	6.05 m / 19 ft. 10 in.		44.70 m ² / 481 ft ²	4	5

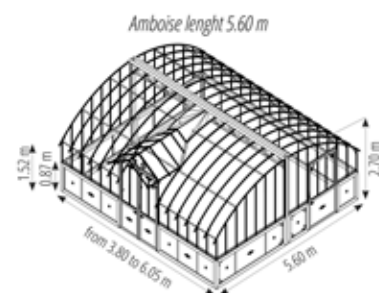

OPTIONS			
PRODUCT	LENGTH	PRODUCT	LENGTH
Shading system Width 5.60 m / 7.40 m 18 ft. 5 in. / 24 ft. 3 in.	3.80 m / 12 ft. 5 in.	Additional door on left gable side	l. 1.00 x H. 1.95 m / W. 39.3 in. x H. 76.7 in.
	4.55 m / 14 ft. 11 in.	Additional door on right gable side	
	5.30 m / 17 ft. 4 in.	Ridge cresting with 3 spikes (dormer included)	3.80 + 3.11 m / 12 ft. 5 in. + 10 ft. 2 in.
	6.05 m / 19 ft. 10 in.		4.55 + 3.11 m / 14 ft. 11 in. + 10 ft. 2 in.
Set of 10 hanging hooks	/		5.30 + 3.11 m / 17 ft. 4 in. + 10 ft. 2 in.
			6.05 + 3.11 m / 19 ft. 10 in. + 10 ft. 2 in.



33.90 m² (342 ft²) - 6.05 x 5.60 m (19 ft. 10 in. x 18 ft. 5 in.) - Signal black RAL 9004 matte





67.80 m² (730 ft²) - 12.10 x 5.60 m (39 ft. 8 in. x 18 ft. 5 in.) - Signal black RAL 9004 matte







MIRABEAU

The Mirabeau glasshouse can be installed on a baseplate or a wall. It has a double swing door under a dormer. Its design is inspired from the glasshouses of the past.

The Montesquieu glasshouse (page 17) has a similar style but leaned against a supporting wall.



14.80 m² (153 ft²) - 5.30 x 2.80 m (17 ft. 4 in. x 9 ft. 2 in.) - Fir green RAL 6009 matte



14.80 m² (153 ft²) - 5.30 x 2.80 m (17 ft. 4 in. x 9 ft. 2 in.) - Pebble grey RAL 7032 matte



21.15 m² (228 ft²) - 7.55 x 2.80 m (24 ft. 9 in. x 9 ft. 2 in.) - White RAL 9003 matte



14.80 m² (153 ft²) - 5.30 x 2.80 m (17 ft. 4 in. x 9 ft. 2 in.) - Fir green RAL 6009 matte



The shading system is ideal for sun protection

MIRABEAU



With a glazed rear wall, the Mirabeau glasshouse is available on a **40 or 87 cm (15.7 or 34.2 in.)** high wall or aluminium baseplate with a **2.80 or 3.70 m (9 ft. 2 in. or 12 ft. 2 in.)** width. It is available in 4 lengths from **3.80 to 6.05 m (12 ft. 5 in. to 19 ft. 10 in.)** with a ridge height of **2.70 or 2.90 m (8 ft. 10 in. or 9 ft. 6 in.)**. Other lengths available on demand.

The Mirabeau glasshouse is equipped with:

- > an **aluminium structure**, powder-coated with the colour of your choosing
- > **4 mm tempered glass** on the walls and roof
- > a **dormer** on the front side with a **double swing door** (lock included), size 2 doors x l. 0.70 x H. 2.14 m (W. 27.5 in x H. 84.2 in.)
- > **4 to 8 windows** depending on the glasshouse length.

WIDTH	LENGTH	HEIGHT	SURFACE	NUMBER OF WINDOWS	
				FRONT	REAR
2.80 m / 9 ft. 2 in.	3.80 m / 12 ft. 5 in.	2.70 m / 8 ft. 10 in.	10.60 m ² / 108 ft ²	2	2
	4.55 m / 14 ft. 11 in.		12.70 m ² / 126 ft ²	2	2
	5.30 m / 17 ft. 4 in.		14.80 m ² / 153 ft ²	4	4
	6.05 m / 19 ft. 10 in.		16.90 m ² / 171 ft ²	4	4



WIDTH	LENGTH	HEIGHT	SURFACE	NUMBER OF WINDOWS	
				FRONT	REAR
3.70 m / 12 ft. 2 in.	3.80 m / 12 ft. 5 in.	2.90 m / 9 ft. 6 in.	14.00 m ² / 151 ft ²	2	2
	4.55 m / 14 ft. 11 in.		16.80 m ² / 172 ft ²	2	2
	5.30 m / 17 ft. 4 in.		19.60 m ² / 205 ft ²	4	4
	6.05 m / 19 ft. 10 in.		22.30 m ² / 237 ft ²	4	4

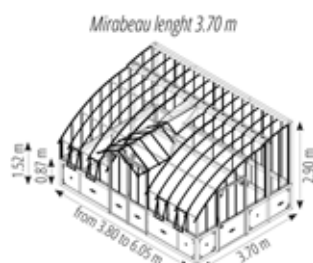

OPTIONS			
PRODUCT	LENGTH	PRODUCT	LENGTH
Shading system Width 2.80 m / 3.70 m 9 ft. 2 in. / 12 ft. 2 in.	3.80 m / 12 ft. 5 in.	Additional door on left gable side	l. 1.00 x H. 1.95 m / W. 39.3 in. x H. 76.7 in.
	4.55 m / 14 ft. 11 in.	Additional door on right gable side	
	5.30 m / 17 ft. 4 in.	Ridge cresting with 3 spikes (dormer included)	3.80 + 3.11 m / 12 ft. 5 in. + 10 ft. 2 in.
	6.05 m / 19 ft. 10 in.		4.55 + 3.11 m / 14 ft. 11 in. + 10 ft. 2 in.
Set of 10 hanging hooks	/		5.30 + 3.11 m / 17 ft. 4 in. + 10 ft. 2 in. 6.05 + 3.11 m / 19 ft. 10 in. + 10 ft. 2 in.





MONTESQUIEU

Set against your house on a baseplate or wall, the Montesquieu glasshouse creates a prestigious entrance to your home.

This elegant glasshouse is equipped with a double door under a dormer and a design inspired by the charm of the glasshouses of the past.

The Mirabeau glasshouse (page 13) offers a similar design with a glazed rear wall.



14.80 m² (153 ft²) - 5.30 x 2.80 m (17 ft. 4 in. x 9 ft. 2 in.) - Olive green RAL 7002 matte



21.15 m² (228 ft²) - 7.55 x 2.80 m (24 ft. 9 in. x 9 ft. 2 in.)
- Nut brown RAL 8011 matte



19.05 m² (205 ft²) - 6.80 x 2.80 m (22 ft. 4 in. x 9 ft. 2 in.)
- Anthracite grey RAL 7016 matte



MONTESQUIEU



25.35 m² (273 ft²) - 9.05 x 2.80 m (29 ft. 8 in. x 9 ft. 2 in.) - Brown RAL 2650 matte

Set against a wall, the Montesquieu glasshouse is available on a **40 or 87 cm (15.7 or 34.2 in.)** high wall or aluminium baseplate with a **2.80 or 3.70 m (9 ft. 2 in. or 12 ft. 2 in.)** width. It is available in 4 lengths from **3.80 to 6.05 m (12 ft. 5 in. to 19 ft. 10 in.)** with a ridge height of **2.70 or 2.90 m (8 ft. 10 in. or 9 ft. 6 in.)**. Other lengths available on demand.

The Montesquieu glasshouse is equipped with:

- > an **aluminium structure**, powder-coated with the colour of your choosing
- > **4 mm tempered glass** on the walls and roof
- > a **dormer** on the front side with a **double swing door** (lock included), size 2 doors x l. 0.70 x H. 2.14 m (W. 27.5 in x H. 84.2 in.)
- > **2 to 4 windows** depending on the glasshouse length.

WIDTH	LENGTH	HEIGHT	SURFACE	NUMBER OF WINDOWS
2.80 m / 9 ft. 2 in.	3.80 m / 12 ft. 5 in.	2.70 m / 8 ft. 10 in.	10.60 m ² / 108 ft ²	2
	4.55 m / 14 ft. 11 in.		12.70 m ² / 126 ft ²	2
	5.30 m / 17 ft. 4 in.		14.80 m ² / 153 ft ²	4
	6.05 m / 19 ft. 10 in.		16.90 m ² / 171 ft ²	4

WIDTH	LENGTH	HEIGHT	SURFACE	NUMBER OF WINDOWS
3.70 m / 12 ft. 2 in.	3.80 m / 12 ft. 5 in.	2.90 m / 9 ft. 6 in.	14.00 m ² / 151 ft ²	2
	4.55 m / 14 ft. 11 in.		16.80 m ² / 172 ft ²	2
	5.30 m / 17 ft. 4 in.		19.60 m ² / 205 ft ²	4
	6.05 m / 19 ft. 10 in.		22.30 m ² / 237 ft ²	4

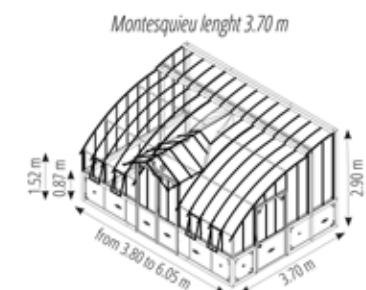

OPTIONS			
PRODUCT	LENGTH	PRODUCT	LENGTH
Shading system Width 2.80 m / 3.70 m 9 ft. 2 in. / 12 ft. 2 in.	3.80 m / 12 ft. 5 in.	Additional door on left gable side	l. 1.00 x H. 1.95 m / W. 39.3 in. x H. 76.7 in.
	4.55 m / 14 ft. 11 in.	Additional door on right gable side	
	5.30 m / 17 ft. 4 in.	Ridge cresting with 3 spikes (dormer included)	3.80 + 3.11 m / 12 ft. 5 in. + 10 ft. 2 in.
	6.05 m / 19 ft. 10 in.		4.55 + 3.11 m / 14 ft. 11 in. + 10 ft. 2 in.
Set of 10 hanging hooks	/		5.30 + 3.11 m / 17 ft. 4 in. + 10 ft. 2 in.
			6.05 + 3.11 m / 19 ft. 10 in. + 10 ft. 2 in.





VERSAILLES

The Versailles glasshouse can be installed on a wall or a baseplate. It has a glazed rear wall and a side door. With its curved, sober and elegant lines it will add charm to your garden.

The Chambord glasshouse (page 25) has a similar style but leaned against a supporting wall.





10.60 m² (108 ft²) - 3.80 x 2.80 m (12 ft. 5 in. x 9 ft. 2 in.) - Black RAL 9004 matte



10.60 m² (108 ft²) - 3.80 x 2.80 m (12 ft. 5 in. x 9 ft. 2 in.) - Blue RAL 2077 matte

VERSAILLES



16.90 m² (171 ft²) - 6.05 x 2.80 m (19 ft. 10 in. x 9 ft. 2 in.)

With a glazed rear wall, the Versailles glasshouse is available on a **40 or 87 cm (15.7 or 34.2 in.)** high baseplate or wall with a **2.80 or 3.70 m (9 ft. 2 in. or 12 ft. 2 in.)** width. It is available in 4 lengths from **3.80 to 6.05 m (12 ft. 5 in. to 19 ft. 10 in.)** with a ridge height of **2.70 or 2.90 m (8 ft. 10 in. or 9 ft. 6 in.)**. Other lengths available on demand.

The Versailles glasshouse is equipped with:

- > an **aluminium structure**, powder-coated with the colour of your choosing
- > **4 mm tempered glass** on the walls and roof
- > a **single swing door** on the side (lock included), size l. 1.00 x H. 1.95 m (W. 39.3 in. x H. 76.7 in.)
- > **4 to 8 windows** depending on the glasshouse length.

WIDTH	LENGTH	HEIGHT	SURFACE	NUMBER OF WINDOWS	
				FRONT	REAR
2.80 m / 9 ft. 2 in.	3.80 m / 12 ft. 5 in.	2.70 m / 8 ft. 10 in.	10.60 m ² / 108 ft ²	2	2
	4.55 m / 14 ft. 11 in.		12.70 m ² / 126 ft ²	3	2
	5.30 m / 17 ft. 4 in.		14.80 m ² / 153 ft ²	4	4
	6.05 m / 19 ft. 10 in.		16.90 m ² / 171 ft ²	5	4

WIDTH	LENGTH	HEIGHT	SURFACE	NUMBER OF WINDOWS	
				FRONT	REAR
3.70 m / 12 ft. 2 in.	3.80 m / 12 ft. 5 in.	2.90 m / 9 ft. 6 in.	14.00 m ² / 151 ft ²	2	2
	4.55 m / 14 ft. 11 in.		16.80 m ² / 172 ft ²	3	2
	5.30 m / 17 ft. 4 in.		19.60 m ² / 205 ft ²	4	4
	6.05 m / 19 ft. 10 in.		22.30 m ² / 237 ft ²	5	4

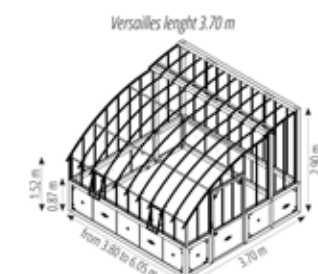

OPTIONS			
PRODUCT	LENGTH	PRODUCT	LENGTH
Shading system Width 2.80 m / 3.70 m 9 ft. 2 in. / 12 ft. 2 in.	3.80 m / 12 ft. 5 in.	Additional door on left gable side	l. 1.00 x H. 1.95 m / W. 39.3 in. x H. 76.7 in.
	4.55 m / 14 ft. 11 in.	Additional door on right gable side	
	5.30 m / 17 ft. 4 in.	Ridge cresting with 2 spikes	3.80 m / 12 ft. 5 in.
	6.05 m / 19 ft. 10 in.		4.55 m / 14 ft. 11 in.
Set of 10 hanging hooks	/		5.30 m / 17 ft. 4 in.
			6.05 m / 19 ft. 10 in.





CHAMBORD

Set against your house or a simple wall, on a baseplate or wall, the Chambord glasshouse is a charming winter garden.

This glasshouse, with its simple elegance and curves, comes with lateral door.

The Versailles glasshouse (page 21) offers a similar design with a glazed rear wall.



10.60 m² (108 ft²) - 3.80 x 2.80 m (12 ft. 5 in. x 9 ft. 2 in.) - Signal black RAL 9004 matte



10.60 m² (108 ft²) - 3.80 x 2.80 m (12 ft. 5 in. x 9 ft. 2 in.) - Signal black RAL 9004 matte



10.60 m² (108 ft²) - 3.80 x 2.80 m (12 ft. 5 in. x 9 ft. 2 in.) - Telegrey 1 RAL 7045 matte



16.90 m² (171 ft²) - 6.05 x 2.80 m (19 ft. 10 in. x 9 ft. 2 in.) - Olive green RAL 6003 matte



14.00 m² (151 ft²) - 3.80 x 3.70 m (12 ft. 5 in. x 12 ft. 2 in.) - Pebble grey RAL 7032 matte

CHAMBORD



16.90 m² (171 ft²) - 6.05 x 2.80 m (19 ft. 10 in. x 9 ft. 2 in.) - Fir green RAL 6009 matte

Set against a wall, the Chambord glasshouse is available on a **40 or 87 cm (15.7 or 34.2 in.)** high baseplate or wall with a **2.80 or 3.70 m (9 ft. 2 in. or 12 ft. 2 in.)** width. It is available in 4 lengths from **3.80 to 6.05 m (12 ft. 5 in. to 19 ft. 10 in.)** with a ridge height of **2.70 or 2.90 m (8 ft. 10 in. or 9 ft. 6 in.)**. Other lengths available on demand.

The Chambord glasshouse is equipped with:

- > an **aluminium structure**, powder-coated with the colour of your choosing
- > **4 mm tempered glass** on the walls and roof
- > a **single swing door** on the side (lock included), size l. 1.00 x H. 1.95 m (W. 39.3 in. x H. 76.7 in.)
- > **2 to 5 windows** depending on the glasshouse length.

WIDTH	LENGTH	HEIGHT	SURFACE	NUMBER OF WINDOWS
2.80 m / 9 ft. 2 in.	3.80 m / 12 ft. 5 in.	2.70 m / 8 ft. 10 in.	10.60 m ² / 108 ft ²	2
	4.55 m / 14 ft. 11 in.		12.70 m ² / 126 ft ²	3
	5.30 m / 17 ft. 4 in.		14.80 m ² / 153 ft ²	4
	6.05 m / 19 ft. 10 in.		16.90 m ² / 171 ft ²	5

WIDTH	LENGTH	HEIGHT	SURFACE	NUMBER OF WINDOWS
3.70 m / 12 ft. 2 in.	3.80 m / 12 ft. 5 in.	2.90 m / 9 ft. 6 in.	14.00 m ² / 151 ft ²	2
	4.55 m / 14 ft. 11 in.		16.80 m ² / 172 ft ²	3
	5.30 m / 17 ft. 4 in.		19.60 m ² / 205 ft ²	4
	6.05 m / 19 ft. 10 in.		22.30 m ² / 237 ft ²	5

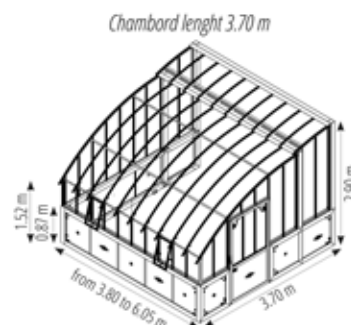
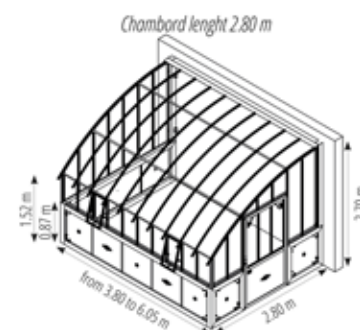

OPTIONS			
PRODUCT	LENGTH	PRODUCT	LENGTH
Shading system Width 2.80 m / 3.70 m 9 ft. 2 in. / 12 ft. 2 in.	3.80 m / 12 ft. 5 in.	Additional door on left gable side	l. 1.00 x H. 1.95 m / W. 39.3 in. x H. 76.7 in.
	4.55 m / 14 ft. 11 in.	Additional door on right gable side	
	5.30 m / 17 ft. 4 in.	Ridge cresting with 2 spikes	3.80 m / 12 ft. 5 in.
	6.05 m / 19 ft. 10 in.		4.55 m / 14 ft. 11 in.
Set of 10 hanging hooks	/		5.30 m / 17 ft. 4 in.
			6.05 m / 19 ft. 10 in.

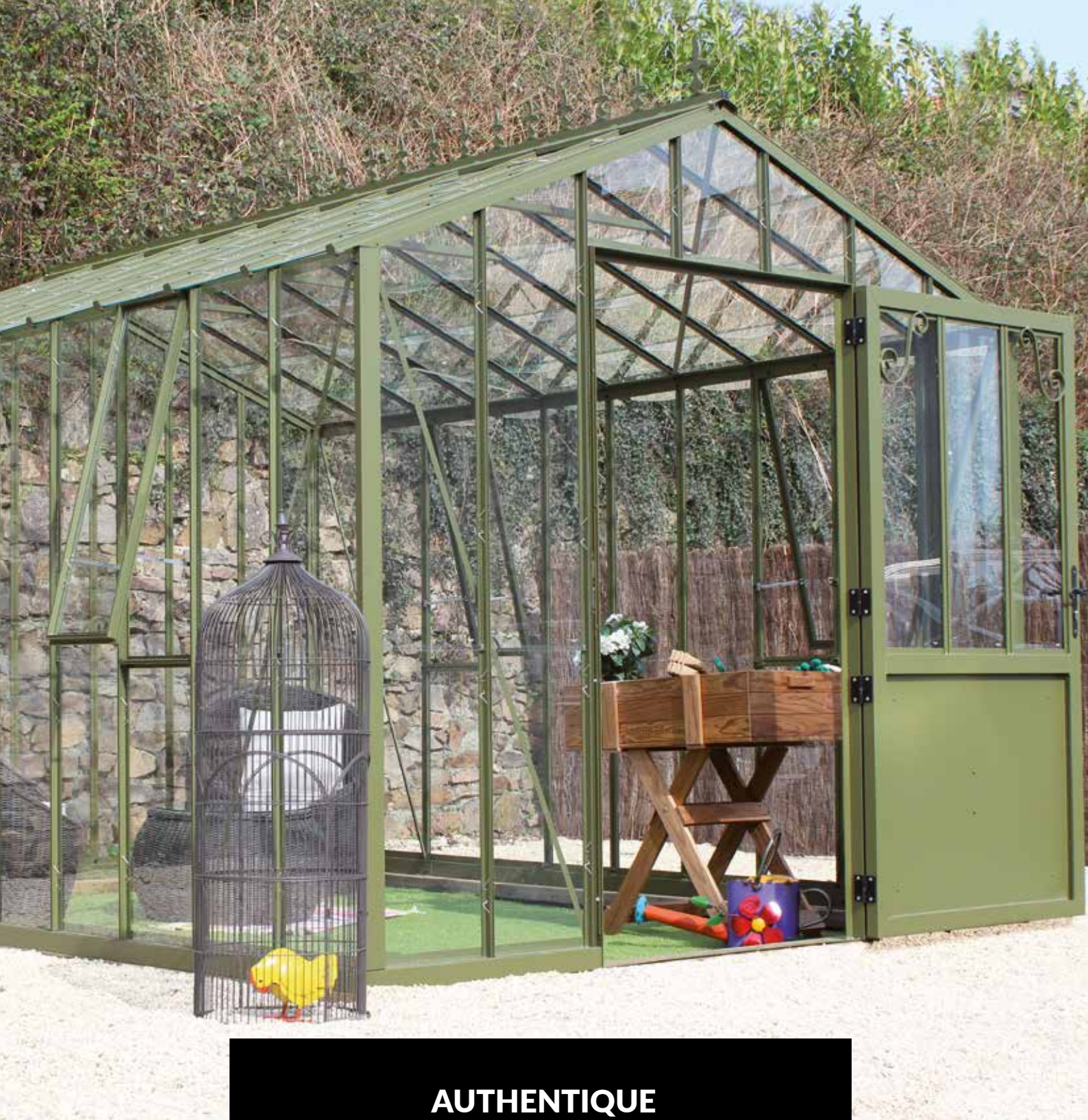

AUTHENTIQUE

It is a fully glazed glasshouse with a retro look that combines simplicity and elegance.

AUTHENTIQUE



10.40 m² (108 ft²) - 3.80 x 2.75 m (12 ft. 5 in. x 9 ft.) - Olive green RAL 2100 matte

The Authentique glasshouse is placed on a **9 cm (3.5 in.)** high base frame. With a **2.75 or 3.50 m (9 ft. or 11 ft. 6 in.)** width, it is available in 7 lengths from **1.50 to 6.05 m (4 ft. 11 in. to 19 ft. 10 in.)** with a ridge height of **2.50 or 2.65 m (8 ft. 2 in. or 8 ft. 8 in.)**.

The Authentique glasshouse is equipped with:

- > an **aluminium structure**, powder-coated with the colour of your choosing
- > **4 mm tempered glass** on the walls and roof
- > a **single swing door** on the front (lock included), size l. 1.00 x H. 1.95 m (W. 39.3 in. x H. 76.7 in.)
- > **2 to 10 windows** depending on the glasshouse length.

WIDTH	LENGTH	HEIGHT	SURFACE	WINDOWS
2.75 m / 9 ft.	1.50 m / 4 ft. 11 in.	2.50 m / 8 ft. 2 in.	4.10 m ² / 36 ft ²	2
	2.30 m / 7 ft. 6.6 in.		6.30 m ² / 63 ft ²	4
	3.05 m / 10 ft.		8.40 m ² / 90 ft ²	4
	3.80 m / 12 ft. 5 in.		10.40 m ² / 108 ft ²	4
	4.55 m / 14 ft. 11 in.		12.50 m ² / 126 ft ²	6
	5.30 m / 17 ft. 4 in.		14.60 m ² / 153 ft ²	8
	6.05 m / 19 ft. 10 in.		16.70 m ² / 171 ft ²	10

WIDTH	LENGTH	HEIGHT	SURFACE	WINDOWS
3.50 m / 11 ft. 6 in.	1.50 m / 4 ft. 11 in.	2.65 m / 8 ft. 8 in.	5.20 m ² / 56 ft ²	2
	2.30 m / 7 ft. 6.6 in.		8.00 m ² / 86 ft ²	4
	3.05 m / 10 ft.		10.60 m ² / 114 ft ²	4
	3.80 m / 12 ft. 5 in.		13.30 m ² / 143 ft ²	4
	4.55 m / 14 ft. 11 in.		15.90 m ² / 162 ft ²	6
	5.30 m / 17 ft. 4 in.		18.55 m ² / 194 ft ²	8
	6.05 m / 19 ft. 10 in.		21.10 m ² / 226 ft ²	10

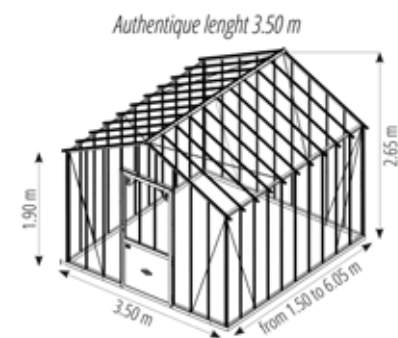

OPTIONS			
PRODUCT	LENGTH	PRODUCT	LENGTH
Shading system Width 2.75 m / 3.50 m 9 ft. / 11 ft. 6 in.	1.50 m / 4 ft. 11 in.	Ridge cresting with 2 spikes	1.50 m / 4 ft. 11 in.
	2.30 m / 7 ft. 6.6 in.		2.30 m / 7 ft. 6.6 in.
	3.05 m / 10 ft.		3.05 m / 10 ft.
	3.80 m / 12 ft. 5 in.		3.80 m / 12 ft. 5 in.
	4.55 m / 14 ft. 11 in.		4.55 m / 14 ft. 11 in.
	5.30 m / 17 ft. 4 in.		5.30 m / 17 ft. 4 in.
	6.05 m / 19 ft. 10 in.		6.05 m / 19 ft. 10 in.
Set of 10 hanging hooks	/	Additional door on the rear gable side	l. 1.00 x H. 1.95 m / W. 39.3 in. x H. 76.7 in.



CLASSIQUE

This glasshouse can be installed on a wall or a baseplate. It has a double-pitched roof and classic glazing style. Rediscover the charm of early 20th century glasshouses!

CLASSIQUE



8.40 m² (90 ft²) - 3.05 x 2.75 m (10 ft. x 9 ft.) - White RAL 9003 matte

The Classique glasshouse is available on a **40 or 87 cm (15.7 or 34.2 in.)** high baseplate or wall. With a **2.75 or 3.50 m (9 ft. or 11 ft. 6 in.)** width, it is available in 7 lengths from **1.50 to 6.05 m (4 ft. 11 in. to 19 ft. 10 in.)** with a ridge height of **2.50 or 2.65 m (8 ft. 2 in. or 8 ft. 8 in.)**.

The Classique glasshouse is equipped with:

- > an **aluminium structure**, powder-coated with the colour of your choosing
- > **4 mm tempered glass** on the walls and roof
- > a **single swing door** on the front (lock included), size l. 1.00 x H. 1.95 m (W. 39.3 in. x H. 76.7 in.)
- > **2 to 10 windows** depending on the glasshouse length.

WIDTH	LENGTH	HEIGHT	SURFACE	WINDOWS
2.75 m / 9 ft.	1.50 m / 4 ft. 11 in.	2.50 m / 8 ft. 2 in.	4.10 m ² / 36 ft ²	2
	2.30 m / 7 ft. 6.6 in.		6.30 m ² / 63 ft ²	4
	3.05 m / 10 ft.		8.40 m ² / 90 ft ²	4
	3.80 m / 12 ft. 5 in.		10.40 m ² / 108 ft ²	4
	4.55 m / 14 ft. 11 in.		12.50 m ² / 126 ft ²	6
	5.30 m / 17 ft. 4 in.		14.60 m ² / 153 ft ²	8
	6.05 m / 19 ft. 10 in.		16.70 m ² / 171 ft ²	10

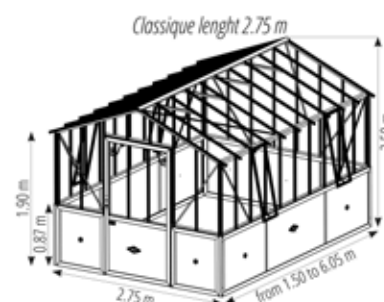

WIDTH	LENGTH	HEIGHT	SURFACE	WINDOWS
3.50 m / 11 ft. 6 in.	1.50 m / 4 ft. 11 in.	2.65 m / 8 ft. 8 in.	5.20 m ² / 56 ft ²	2
	2.30 m / 7 ft. 6.6 in.		8.00 m ² / 86 ft ²	4
	3.05 m / 10 ft.		10.60 m ² / 114 ft ²	4
	3.80 m / 12 ft. 5 in.		13.30 m ² / 143 ft ²	4
	4.55 m / 14 ft. 11 in.		15.90 m ² / 162 ft ²	6
	5.30 m / 17 ft. 4 in.		18.55 m ² / 194 ft ²	8
	6.05 m / 19 ft. 10 in.		21.10 m ² / 226 ft ²	10

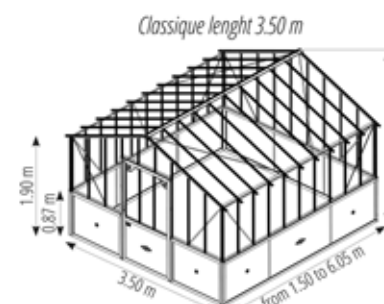

OPTIONS			
PRODUCT	LENGTH	PRODUCT	LENGTH
Shading system Width 2.75 m / 3.50 m 9 ft. / 11 ft. 6 in.	1.50 m / 4 ft. 11 in.	Ridge cresting with 2 spikes	1.50 m / 4 ft. 11 in.
	2.30 m / 7 ft. 6.6 in.		2.30 m / 7 ft. 6.6 in.
	3.05 m / 10 ft.		3.05 m / 10 ft.
	3.80 m / 12 ft. 5 in.		3.80 m / 12 ft. 5 in.
	4.55 m / 14 ft. 11 in.		4.55 m / 14 ft. 11 in.
	5.30 m / 17 ft. 4 in.		5.30 m / 17 ft. 4 in.
	6.05 m / 19 ft. 10 in.		6.05 m / 19 ft. 10 in.
Set of 10 hanging hooks	/	Additional door on the rear gable side	l. 1.00 x H. 1.95 m / W. 39.3 in. x H. 76.7 in.



14.60 m² (153 ft²) - 5.30 x 2.75 m (17 ft. 4 in. x 9 ft.) - Anthracite grey RAL 7016 matte





14.60 m² (153 ft²) - 5.30 x 2.75 m (17 ft. 4 in. x 9 ft.) - Nut brown RAL 8011 matte



10.40 m² (108 ft²) - 3.80 x 2.75 m (12 ft. 5 in. x 9 ft.) - Anthracite grey RAL 7016 matte

YOUR GLASSHOUSE IS DELIVERED TO YOUR HOME BY APPOINTMENT

Your Lams glasshouse and its glazing is delivered to you in a wooden box and a rack designed by our teams to guarantee the best transport conditions.

Package 1: A wooden box including the entire aluminum structure of your glasshouse, the gaskets and the screws (this box is 60 cm x 60 cm (W. 23.6 in. x H. 23.6 in.) and the length corresponds to that of your glasshouse).

Package 2: A wooden rack with all the glazing (size: L. 2.00 x l. 0.80 m (L. 79 in. x W. 31 in.)).

The pallet and the glazing rack are made of douglas fir, a class III rot-proof wood (if not left in permanent contact with wet soil). It is a naturally resistant and nontreated wood, which you can use to make vegetable garden squares, insect hotels, etc. See our chapter on the upcycling of pallets.

The delivery of your glasshouse to your home is operated with a truck equipped with a trolley. You will be asked to specify the accessibility of this truck to your home. The special feature of these trucks is that they can be driven in from the side, as the wheels of the truck can be retracted at 45° (see video).

To decide on the delivery date of your glasshouse, the carrier will contact you to make an appointment the week before the delivery.



Video trolley movement

UPCYCLE YOUR STRUCTURE PALLET AND ITS GLAZING RACK

Here are some of our ideas, from the most simple to the most technical. A 12-page booklet of suggestions is provided with your glasshouse.

Please feel free to send your suggestions and pictures of your work to contact@serres-lams.com.

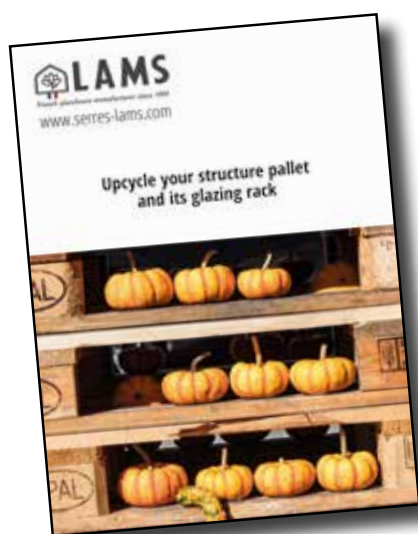

Booklet provided with your glasshouse



The creation of a customer with the glazing rack



What you need: gloves to protect your hands from splinters and nails, a crowbar to separate the boards, a sledgehammer, a saw, pliers to remove and cut the nails, a screwdriver, and screws.

WHAT IS UPCYCLING?

We all strive to recycle. Recycling is the reintroduction of a good into the production cycle from which it came.

Upcycling is a more sophisticated approach to recycling. It involves transforming a good into a product of greater utility or quality than its original purpose.

Vegetable squares and composters

The web is full of ideas on how to make vegetable patches for all tastes and all levels of DIY expertise. Here's one of the easiest things you can do if you want to tame your strawberry plants so they don't get too wild in the garden.

Compost your waste in your upcycled pallet bin. Caution: do not provide a floor under your bin. It should be placed on the ground to welcome earthworms and other beneficial insects.

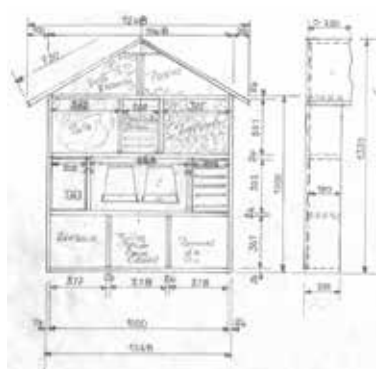

Bug hotel

Where to install your insect house?

It is essential to attract all kinds of insects to the garden. A diverse garden is a healthy garden. Elevate your insect house to protect it from moisture, and place it with its back to the wind, preferably facing south/southeast. Your insect hotel will find its best place near your flower beds or in your vegetable garden, a little aside from your paths.

Bird feeders

Food on a "silver plate"

The sizes of this tray feeder can be varied. However, make sure that the edges are not too high (maximum 2 cm / 0.8 in.). Drill a few 2 mm (0.08 in.) holes in the bottom to allow rainwater to run off.

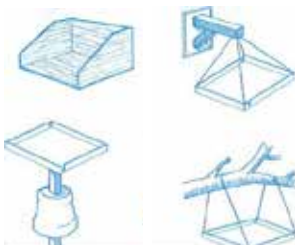

Shelves for your plants and seedlings, a display in your glasshouse!

Do you like DIY and are you an expert in reusing materials? Here are some examples of how to make shelves and display units from a glasshouse pallet and the glazing rack.



The creation of a customer, with more wood than our glass rack offers...





YOUR DEALER

Creator & manufacturer of French glasshouses since 1993

Design: DOVIRIS / Médiapilote - Photos: DOVIRIS - Non-contractual photos and illustrations. Suggestions for presentation.
Printing techniques may cause a slight variation in colour compared to the actual colour of the product. In the limit of the available stock.